

ALLDAY  
& MILLER



Frogmore Avenue, Hayes, UB4 8AR  
£524,000

3 1 2 D



Frogmore Avenue, Hayes, UB4 8AR

**£524,000**

- Three Bedroom Semi Detached
- Garage
- Immaculate Throughout
- Hayes & Harlington Station (Crossrail)
- Sought After North Hayes Location
- Off Street Parking for Multiple Vechiles
- Beautiful Landscaped Garden
- Close to Highly Regarded Schools
- Nash Built
- Potential to Extend (Subject to Planning)

## Description

The accommodation on offer comprises; entrance hall, through lounge with feature fireplace, sleek kitchen that overlooks and provides access to the rear garden.

To the first floor there are three well proportioned bedrooms with fitted wardrobes and a contemporary family bathroom.

### Outside

To the rear there is a stunning landscaped garden that has been mainly laid to lawn with a patio area that is perfect for outside dining and entertaining.

A garage can be approached via a shared driveway with additional parking in front for two cars

## Situation

Frogmore Avenue is a sought after residential road in North Hayes offering easy access to a number of local amenities including shops and bus/road links and a number of highly regarded schools including Hayes Park. The Uxbridge Road is a short distance away and provides access to Hayes town centre with its variety of shops and Elizabeth Line (Crossrail) train station and Uxbridge Town centre with its multitude of shops, bars, restaurants and tube station.



## Floor Plans

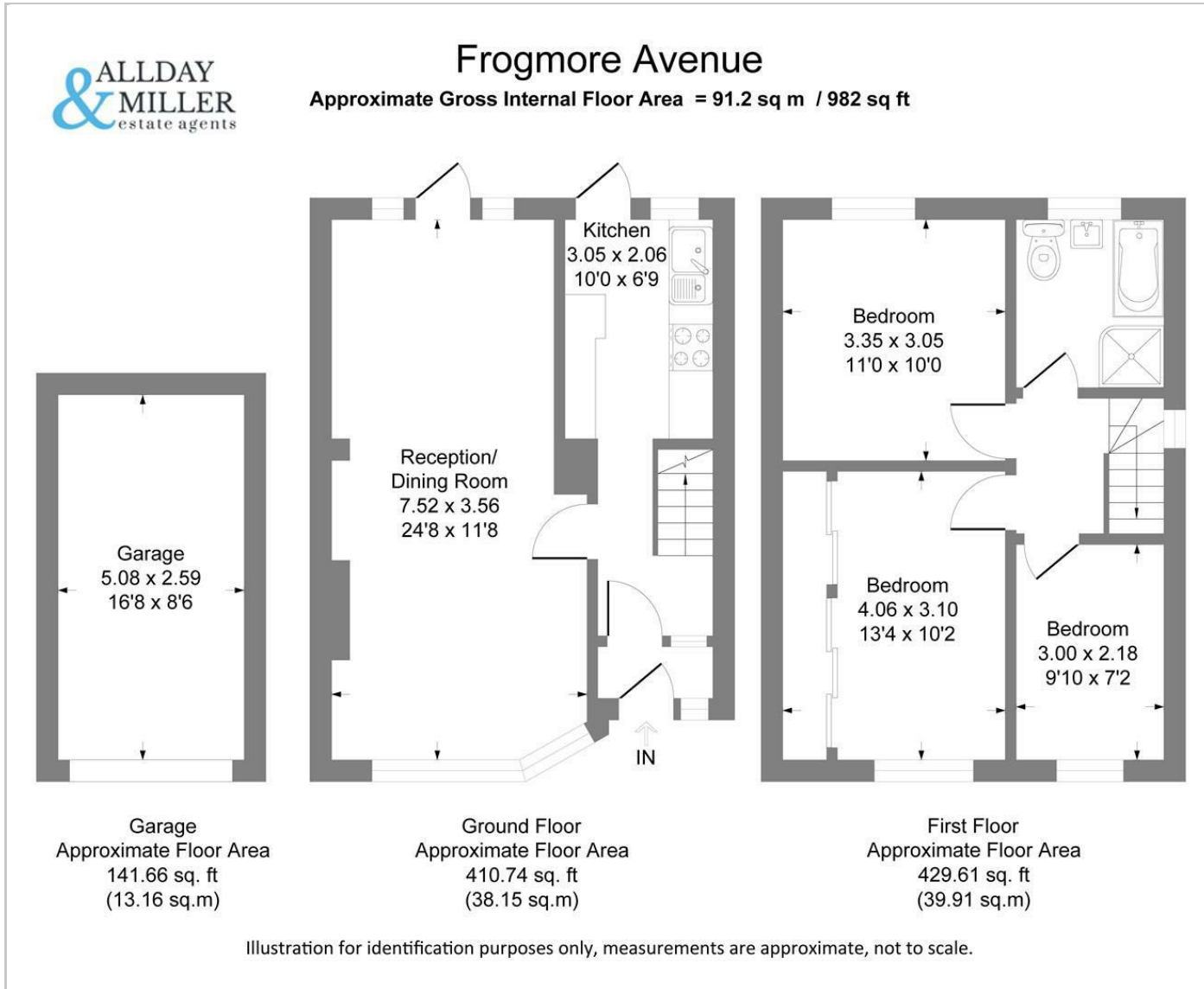

## Area Map

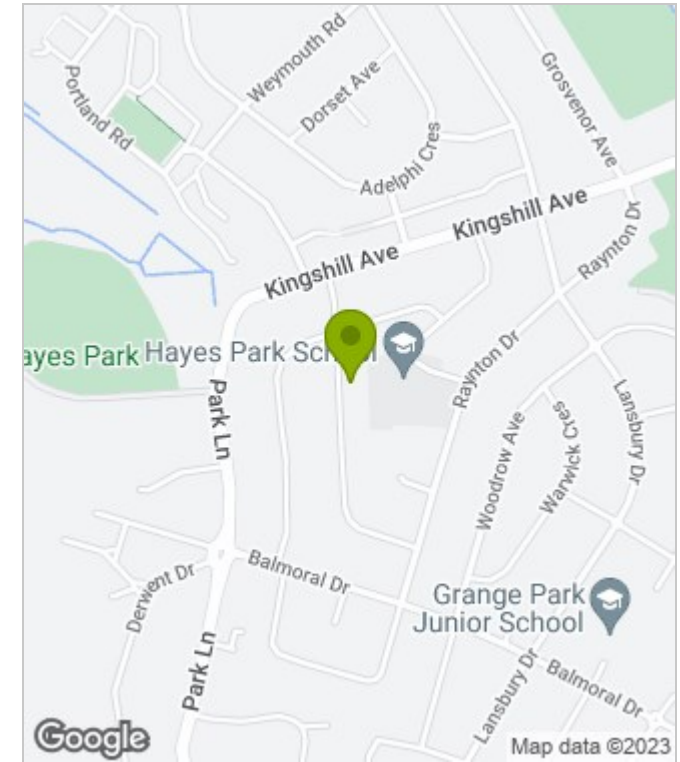

## Energy Performance Graph

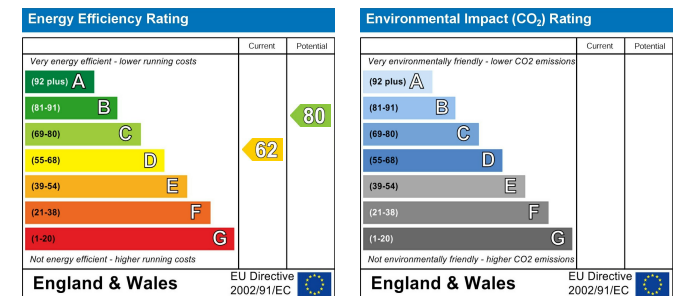

These particulars, whilst believed to be accurate are set out as a general outline only for guidance and do not constitute any part of an offer or contract. Intending purchasers should not rely on them as statements of representation of fact, but must satisfy themselves by inspection or otherwise as to their accuracy. No person in this firm's employment has the authority to make or give any representation or warranty in respect of the property.